

# How To Setup MetaMask Wallet on Your Mobile Device

## 1. Go to AppStore -> Search for “Metamask”

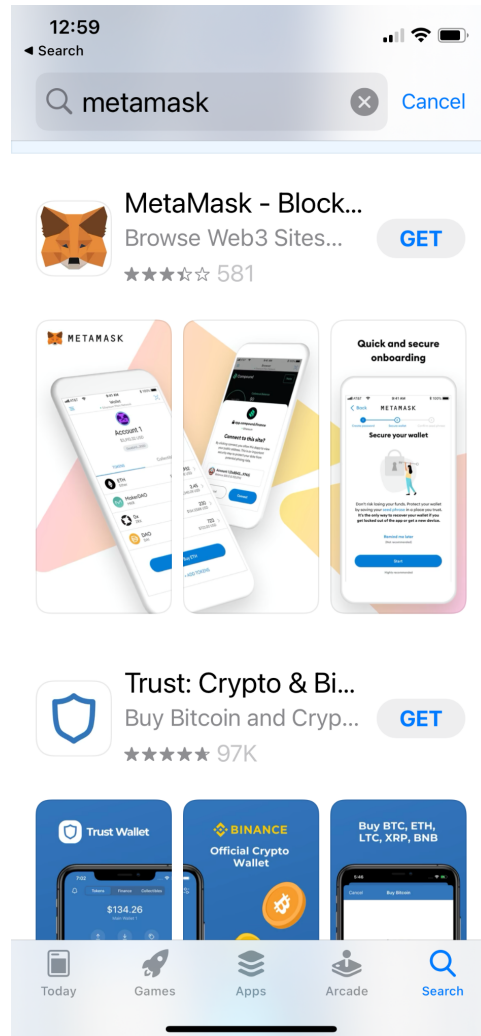

### MetaMask Download Links:

#### U.S.-based Users:

**iOS:** <https://apps.apple.com/us/app/metamask/id1438144202>

**Android:** [https://play.google.com/store/apps/details?id=io.metamask&hl=en\\_US](https://play.google.com/store/apps/details?id=io.metamask&hl=en_US)

#### China-based Users:

**iOS:** <https://apps.apple.com/us/app/metamask/id1438144202>

**Android:** <https://en.softonic.com/download/metamask/android/post-download>

## 2. Click “Get” on “MetaMask - Blockchain Wallet” to download App

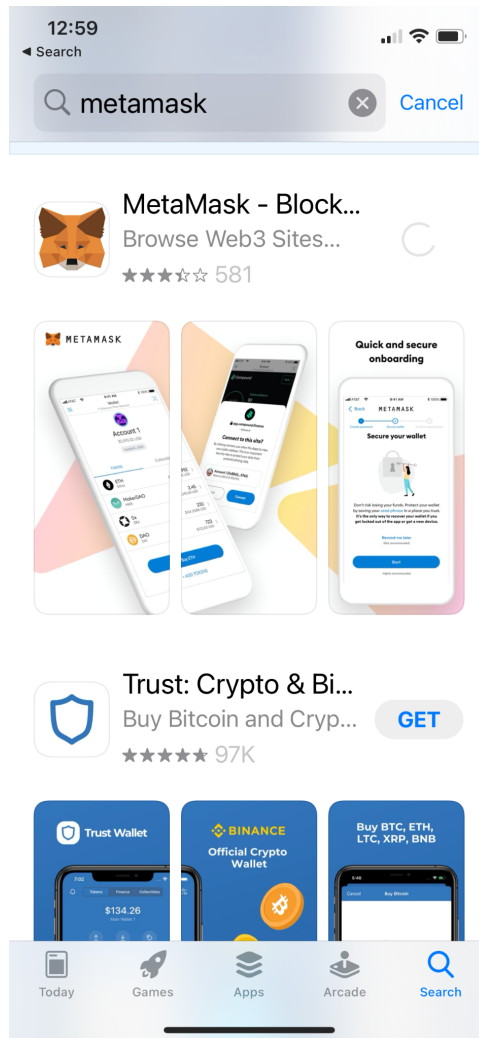

3. After App download completes, open app -> click “Get Started”

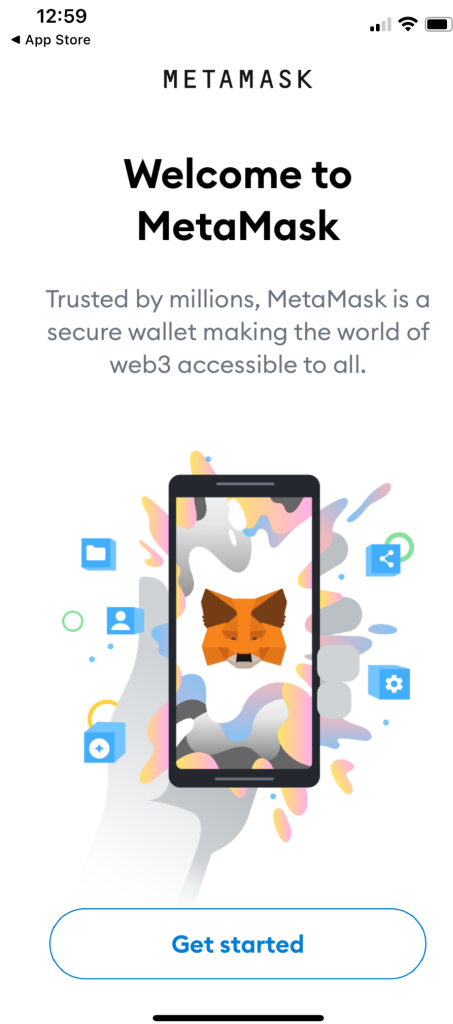

4. Select “Create a New Wallet”

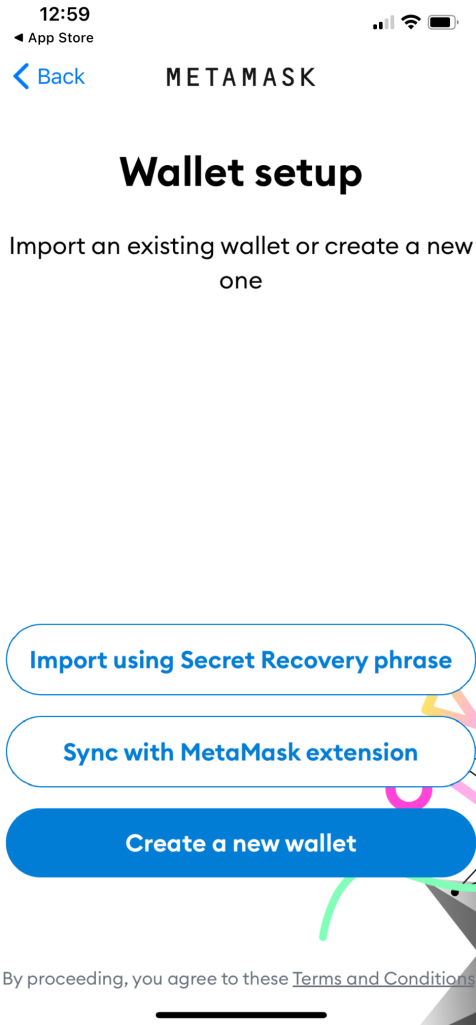

- 5. Create a new password based on specified criteria and Confirm Password**

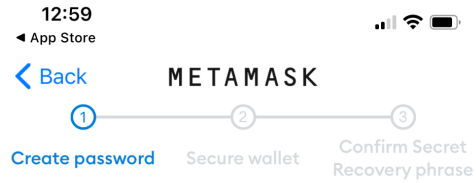

## Create password

This password will unlock your MetaMask wallet only on this device.

New Password Show

Confirm password

Must be at least 8 characters

Sign in with Face ID?



I understand that MetaMask cannot recover this password for me. [Learn more.](#)

6. Once password is confirmed and qualified -> enable Face ID if you'd like and check and agree "I understand password cannot be recovered "

13:00  
App Store

Back METAMASK

1 2 3  
Create password Secure wallet Confirm Secret Recovery phrase

New Password Show

Password strength: **Good**

Confirm password

Must be at least 8 characters

Sign in with Face ID?

I understand that MetaMask cannot recover this password for me. [Learn more.](#)

Create password

7. Click "OK" to enable Face ID authentication

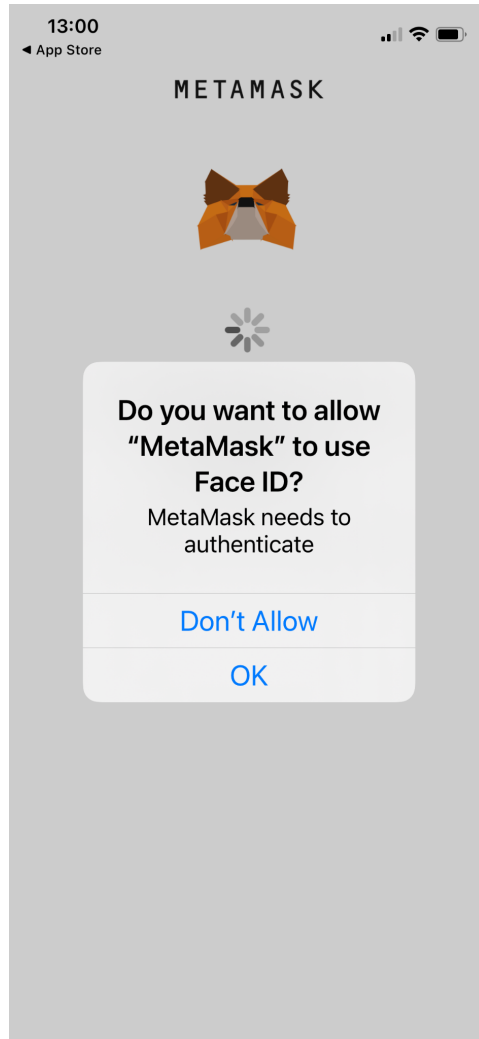

**8. Proceed to Securing Wallet step**

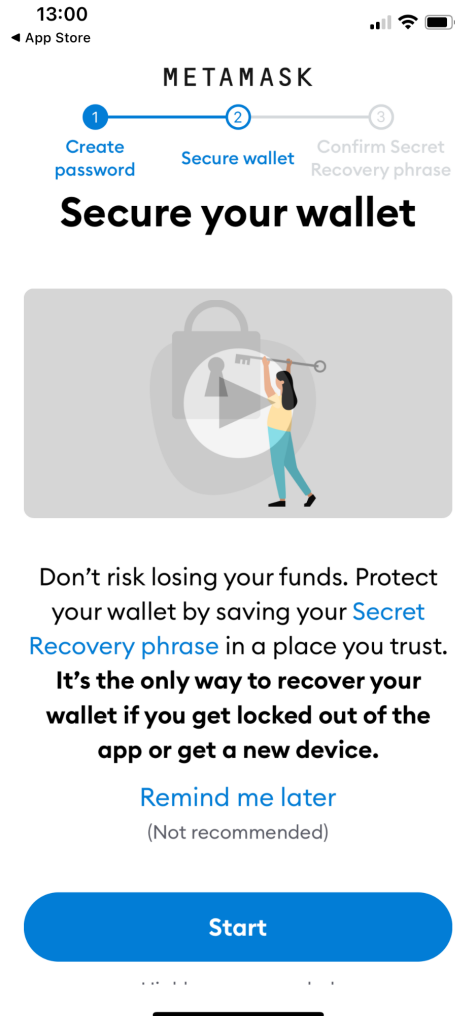

9. Review the precautions of securing your wallet -> click “Start”



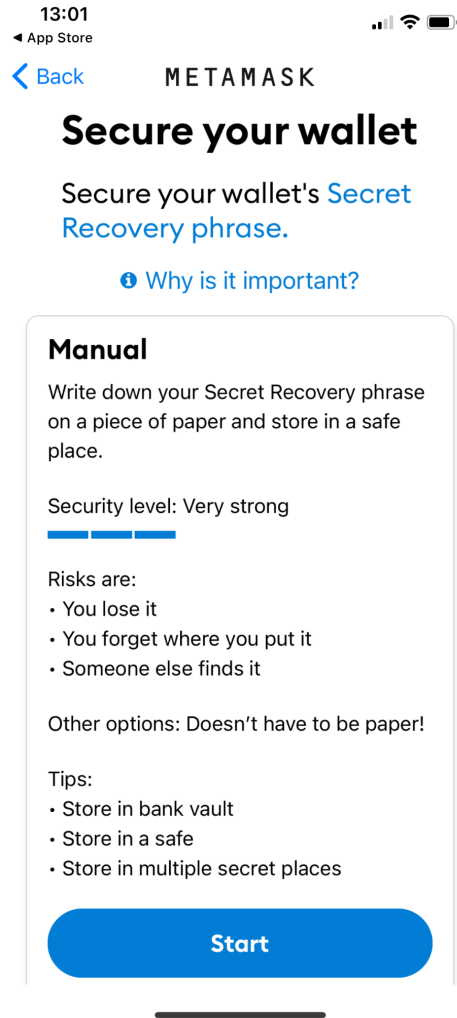

**10. Write down the 12 seed phrase words on a piece of paper**

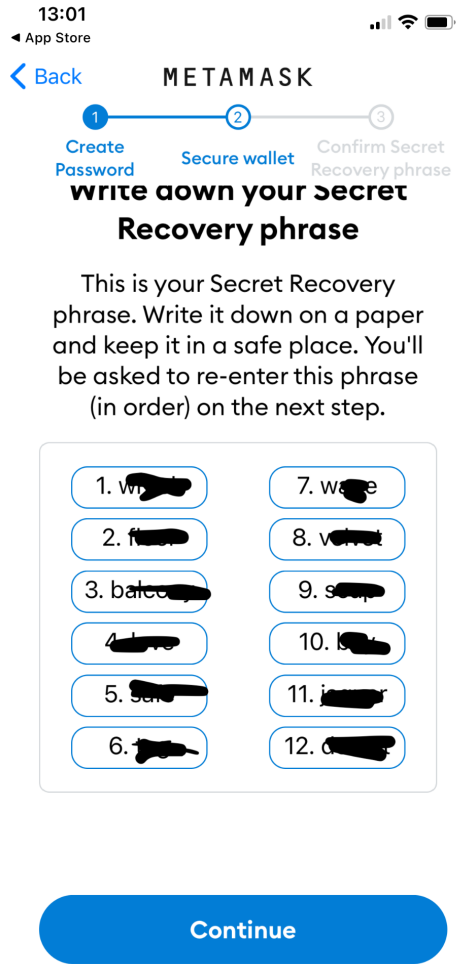

11. Confirm the 12 seed word phrase by re-entering them in the correct order

### Confirm Secret Recovery phrase

Select each word in the order it was presented to you.

1. [redacted]	7. [redacted]
2. [redacted]	8. [redacted]
3. [redacted]	9. [redacted]
4. [redacted]	10. [redacted]
5. [redacted]	11. [redacted]
6. [redacted]	12. [redacted]

✔ Success

Complete Backup

12. Congratulations ! Account created successfully ! -> click Done



# Congratulations

You've successfully protected your wallet. Remember to keep your Secret Recovery phrase safe, it's your responsibility!

[Leave yourself a hint?](#)

MetaMask cannot recover your wallet should you lose it. You can find your

Done

13. Skip the tutorial prompt -> Enter your wallet app

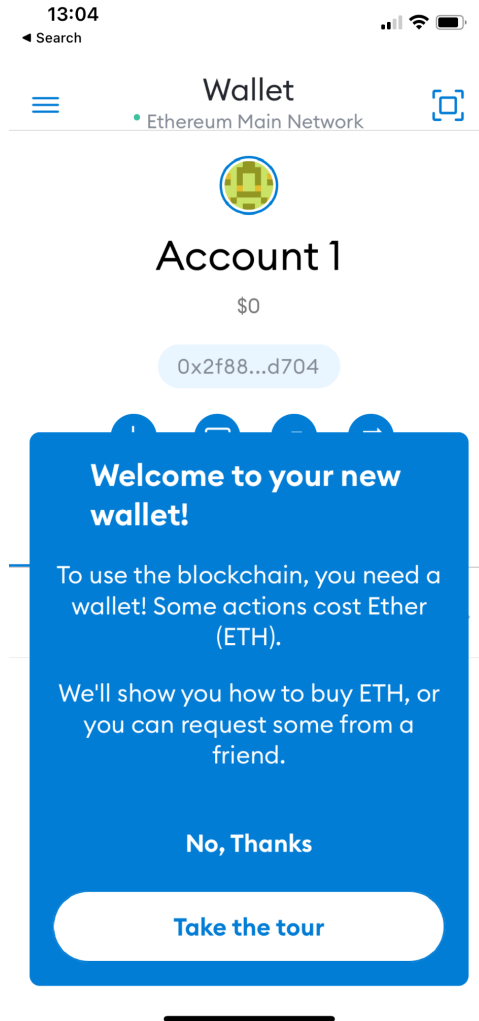

**14. Your newly created account is shown below -> copy and paste your wallet public address "0x...." to share with others**

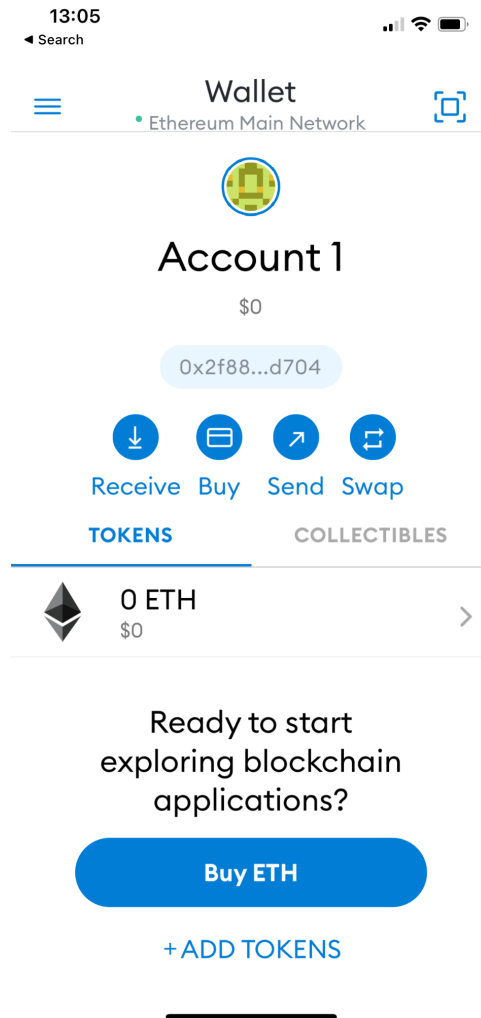

## **\*\*How To Switch from Ethereum Network to Polygon Matic Network\*\***

- 1. From Homepage -> Click Left Top Menu icon -> Click “ Settings “ -> From Settings menu, click “ Networks ” to add a custom network**

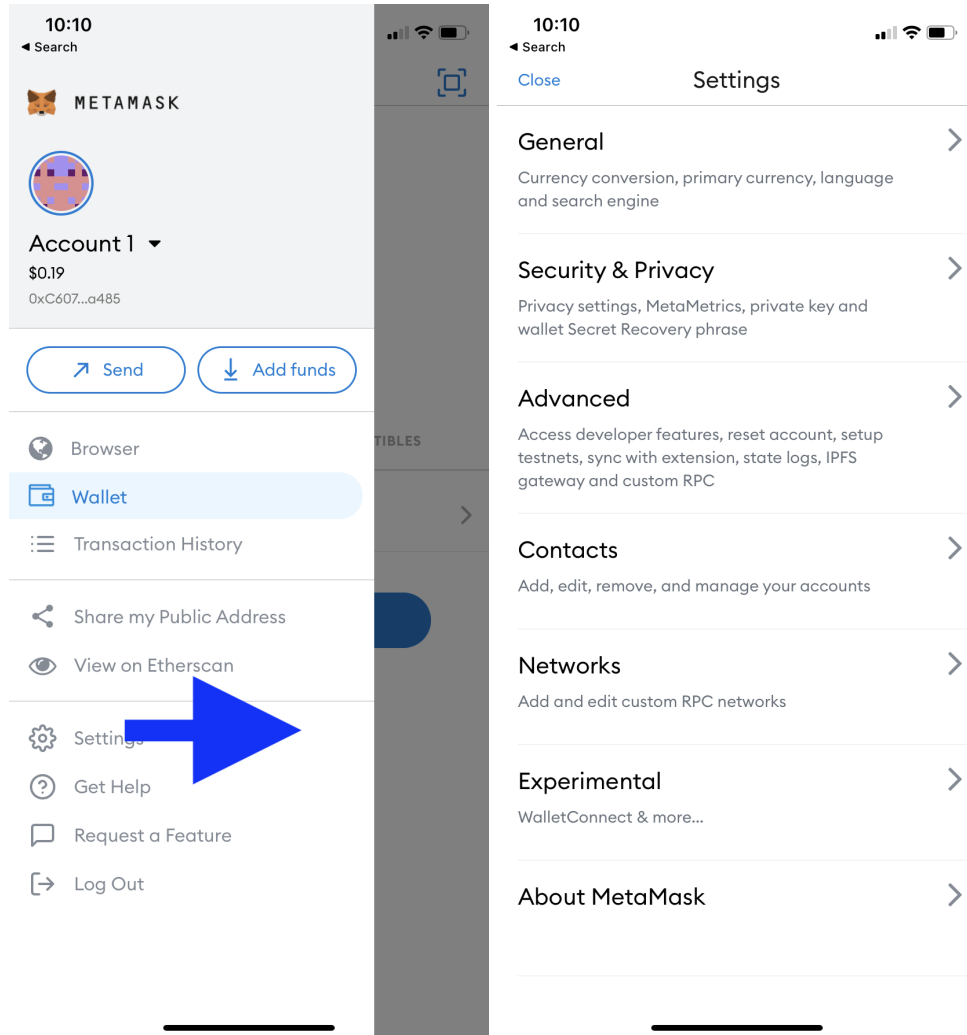

## 2. Click “Add Network “

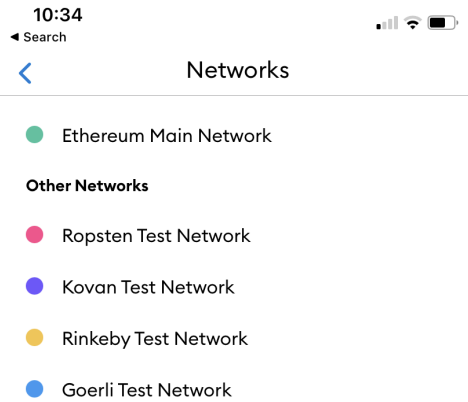

**3. Enter the following information, and click “Add” in order to add Polygon network:**

**Network Name = “ MATIC Mainnet “**  
**RPC Url = “ <https://rpc-mainnet.maticvigil.com> “**  
**Chain ID = “ 137 “**  
**Symbol = “ MATIC “**  
**Block Explorer URL = “ <https://polygonscan.com> “**



< Networks

Network Name

MATIC Mainnet

RPC Url

https://rpc-mainnet.maticvigil.com

Chain ID

137

Symbol

MATIC

Block Explorer URL

https://polygonscan.com

Add

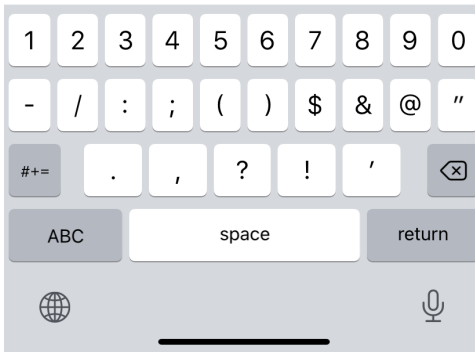

4. Newly added “ Matic Mainnet” will be shown on the Network List -> select and click “Add Network”

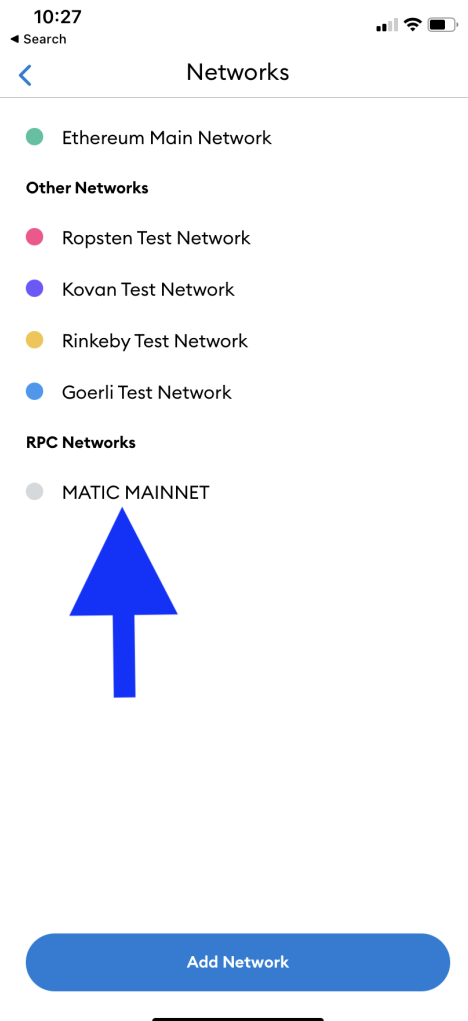

5. Exit to Wallet Homepage -> click on “Wallet” in title bar to expand Network List -> select “MATIC Mainnet” as the Network. You have now successfully switched to MATIC network !

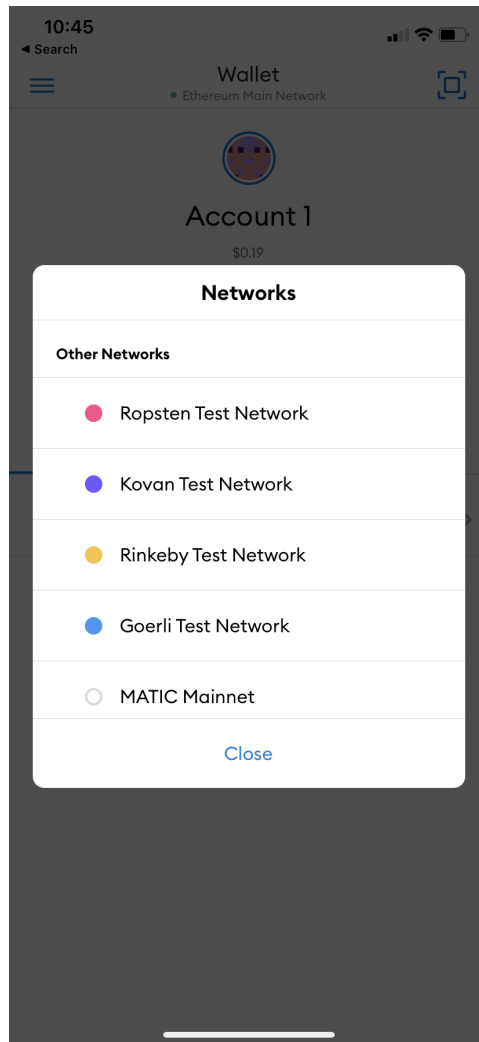

## **\*\*How to Add and Display your WWC Token \*\***

- 1. Long-Click AccountName area ( below Icon) to Edit Account Name to ex. “My WWC Wallet” -> Click “+ Add Tokens” Click “+ Add Tokens”**

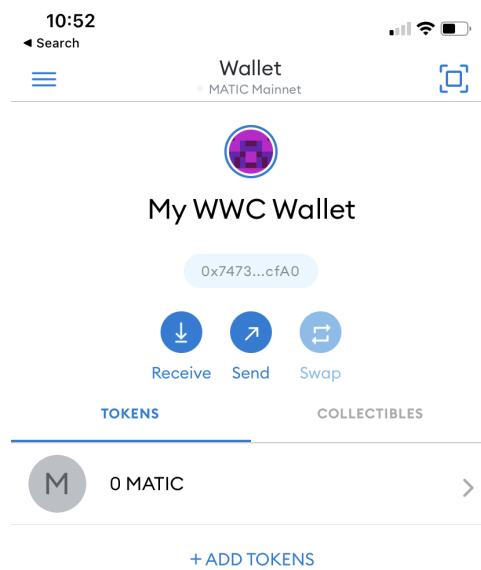

2. Enter Contract Address below in the “Token Address” field:

**0x3EBDC31a24F4A61e5e86399b24F3D19D7fBD869f**

If entered correctly, Token Symbol and Token Precision will be automatically shown:

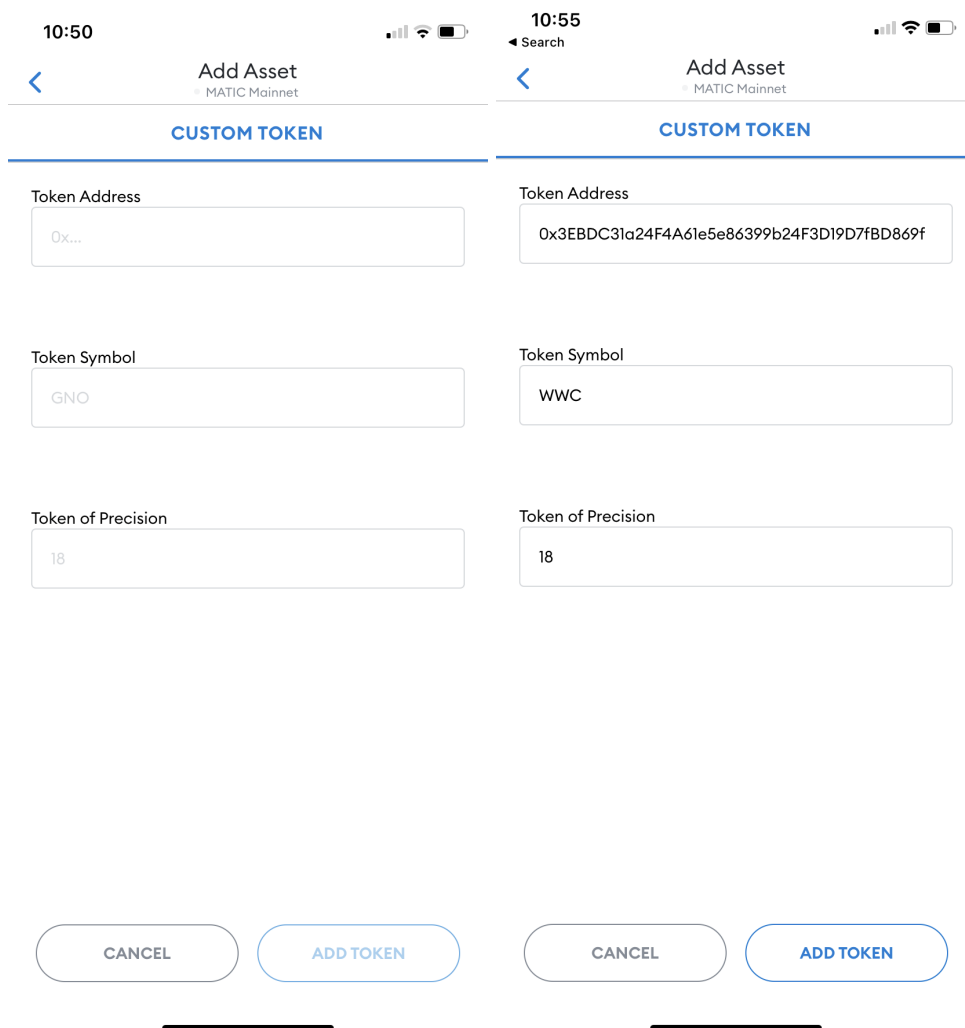

### 3. Now click “Add Token”

10:55 Search Add Asset MATIC Mainnet

**CUSTOM TOKEN**

Token Address  
0x3EBDC31a24F4A61e5e86399b24F3D19D7fBD869f

Token Symbol  
WWC

Token of Precision  
18

CANCEL ADD TOKEN

#### 4. There! Your WWC Token is now listed and displayed on your UFA Wallet !

