

How To Setup MetaMask Wallet on Your Mobile Device

1. Go to AppStore -> Search for “Metamask”

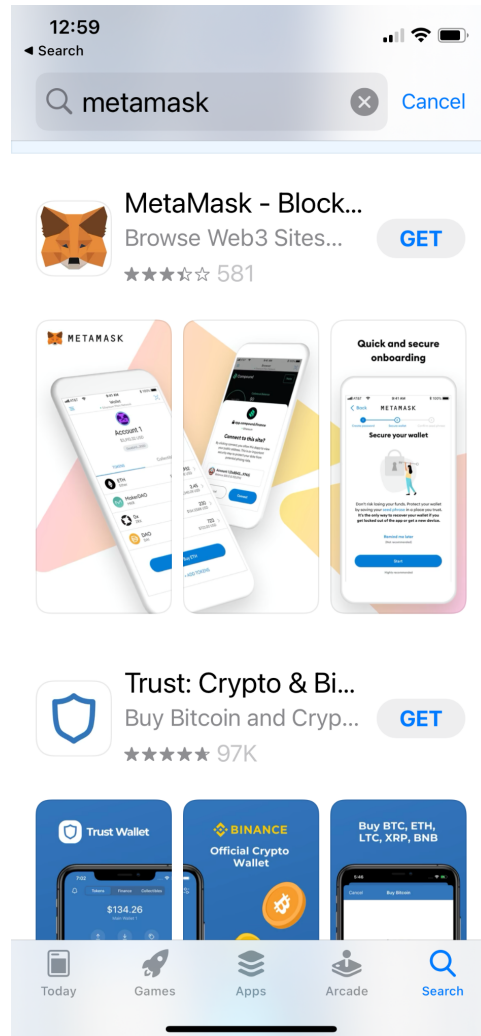

MetaMask Download Links:

U.S.-based Users:

iOS: <https://apps.apple.com/us/app/metamask/id1438144202>

Android: https://play.google.com/store/apps/details?id=io.metamask&hl=en_US

China-based Users:

iOS: <https://apps.apple.com/us/app/metamask/id1438144202>

Android: <https://en.softonic.com/download/metamask/android/post-download>

2. Click “Get” on “MetaMask - Blockchain Wallet” to download App

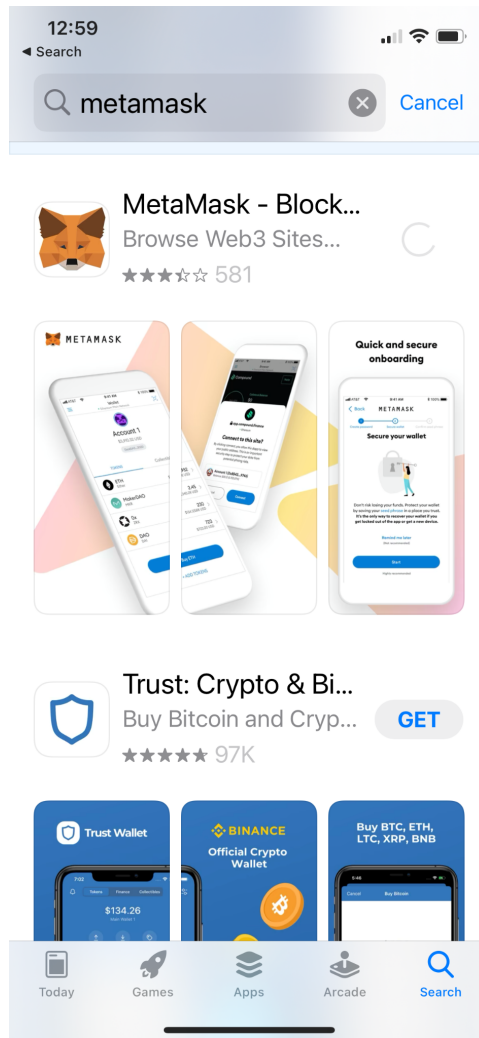

3. After App download completes, open app -> click “Get Started”

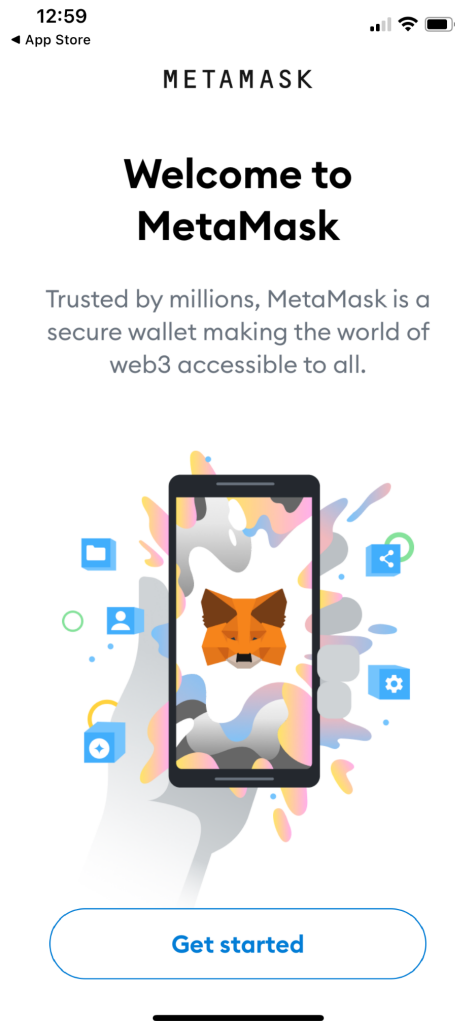

4. Select “Create a New Wallet”

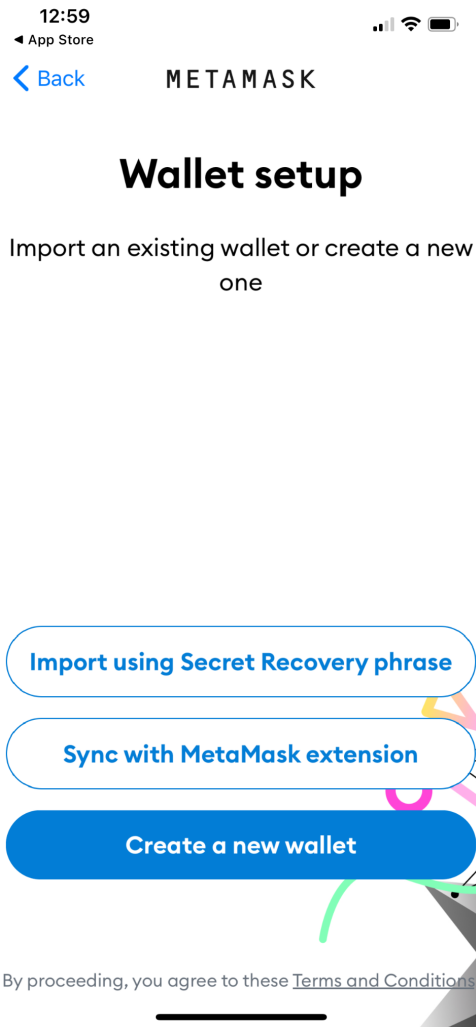

5. **Create a new password based on specified criteria and Confirm Password**

12:59
◀ App Store

◀ Back METAMASK

① — ② — ③

Create password Secure wallet Confirm Secret Recovery phrase

Create password

This password will unlock your MetaMask wallet only on this device.

New Password Show

Confirm password

Must be at least 8 characters

Sign in with Face ID? ☒

☐ I understand that MetaMask cannot recover this password for me. [Learn more.](#)

6. Once password is confirmed and qualified -> enable Face ID if you'd like and check and agree "I understand password cannot be recovered "

13:00
◀ App Store

◀ Back METAMASK

① — ② — ③
Create password Secure wallet Confirm Secret Recovery phrase

New Password Show

Password strength: Good

Confirm password

Must be at least 8 characters

Sign in with Face ID? ☒

☐ I understand that MetaMask cannot recover this password for me. [Learn more.](#)

Create password

7. Click “OK” to enable Face ID authentication

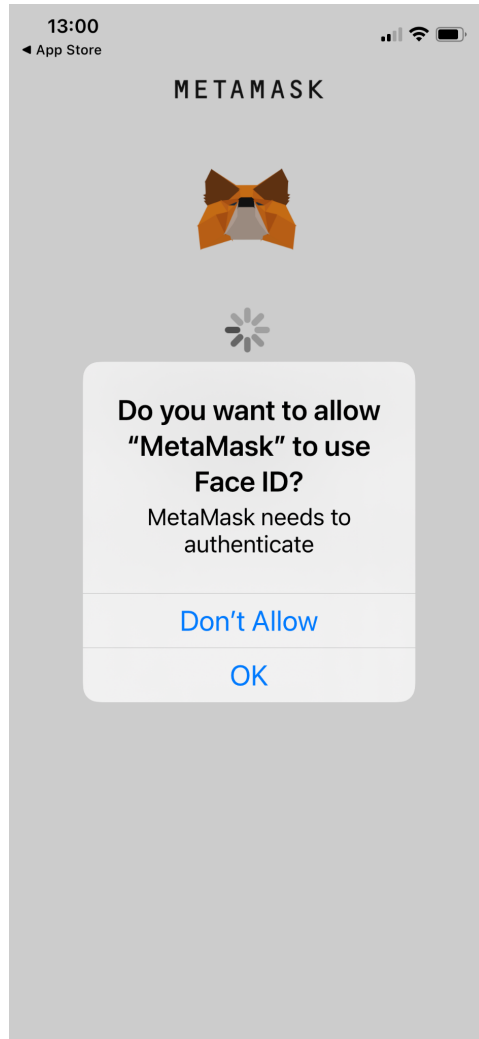

8. Proceed to Securing Wallet step

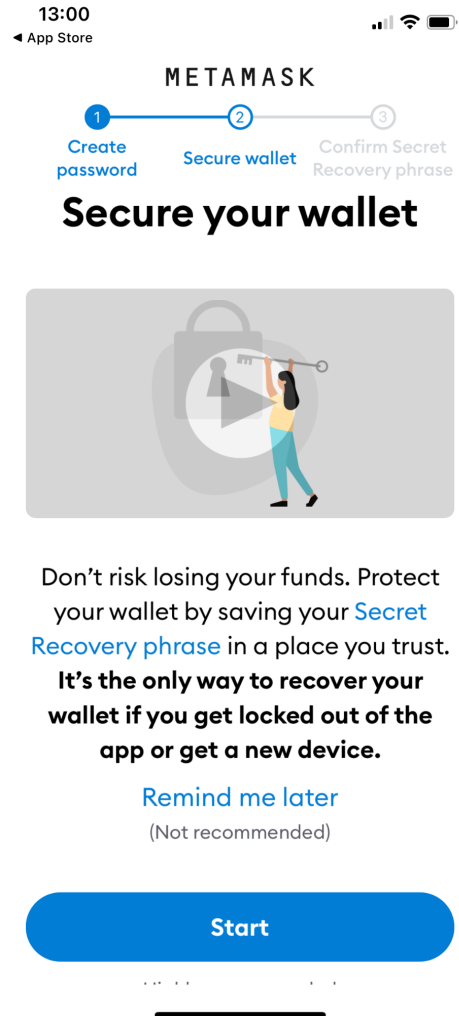

9. Review the precautions of securing your wallet -> click “Start”

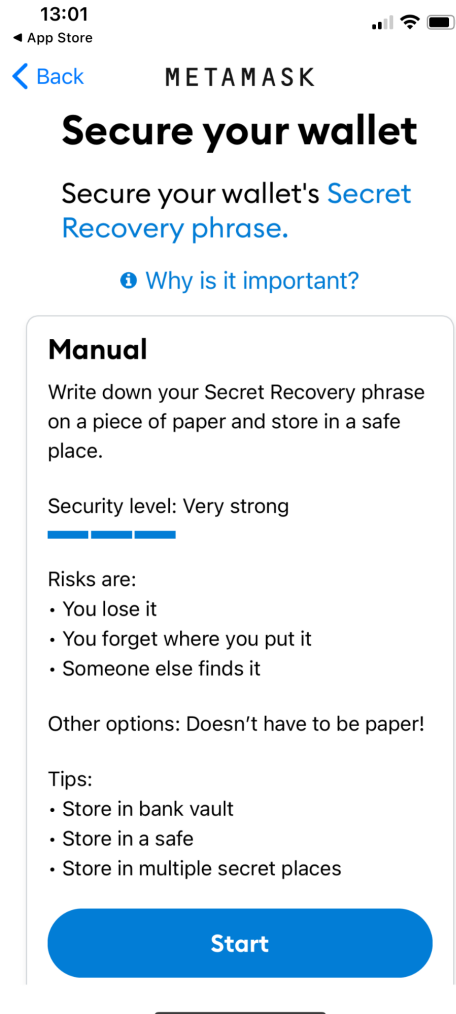

10. Write down the 12 seed phrase words on a piece of paper

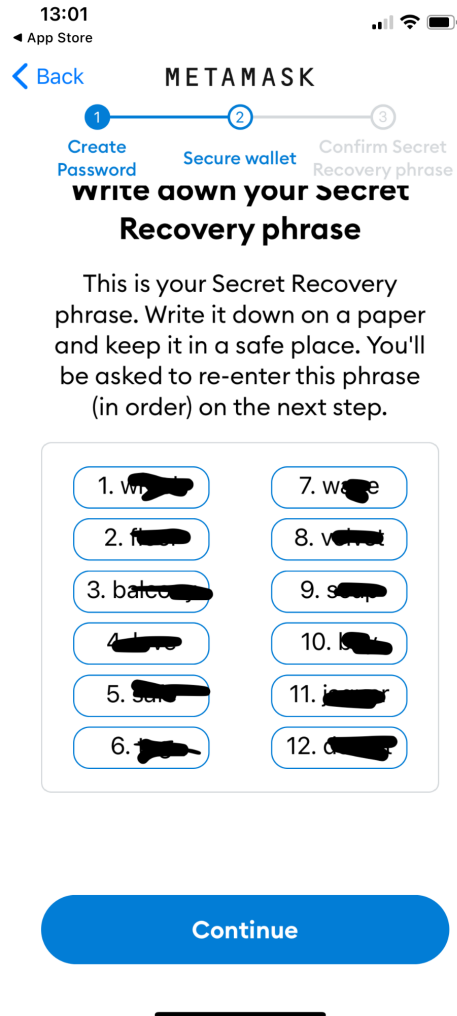

11. Confirm the 12 seed word phrase by re-entering them in the correct order

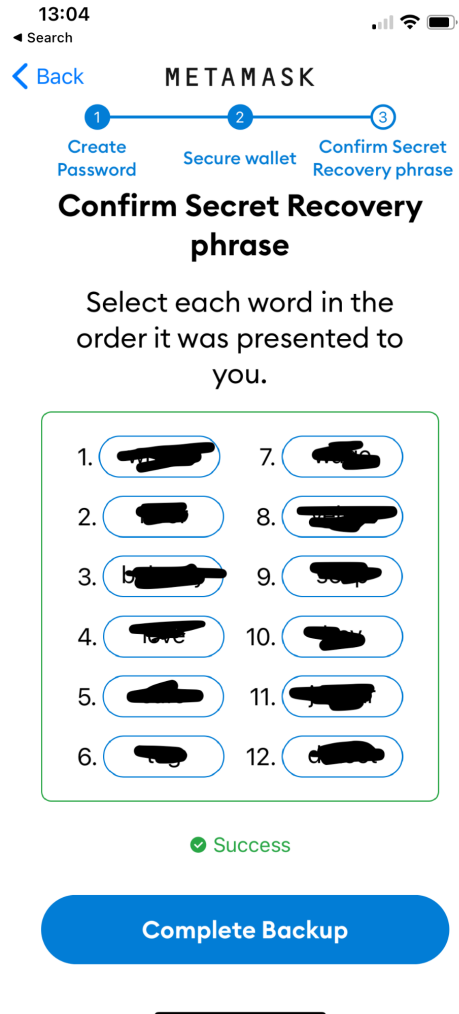

12. Congratulations ! Account created successfully ! -> click Done



13. Skip the tutorial prompt -> Enter your wallet app

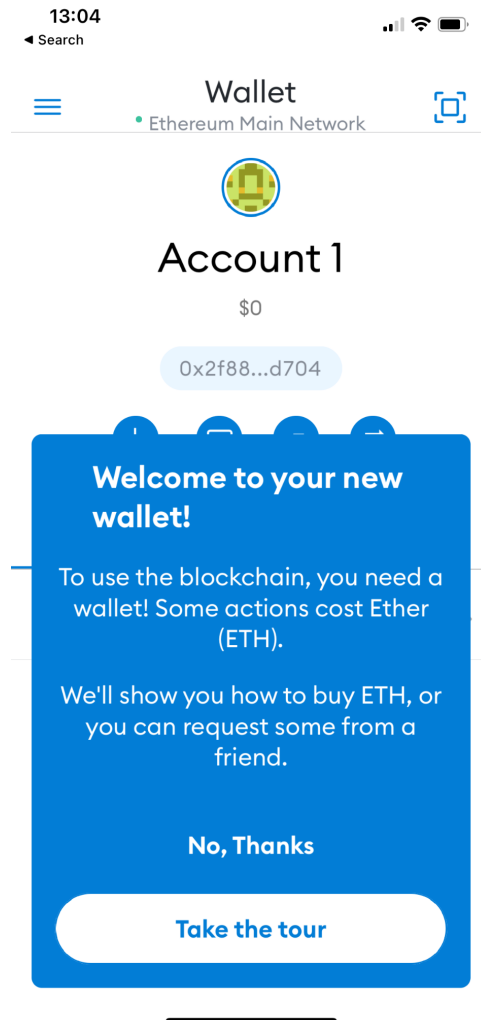

14. Your newly created account is shown below -> copy and paste your wallet public address "0x...." to share with others

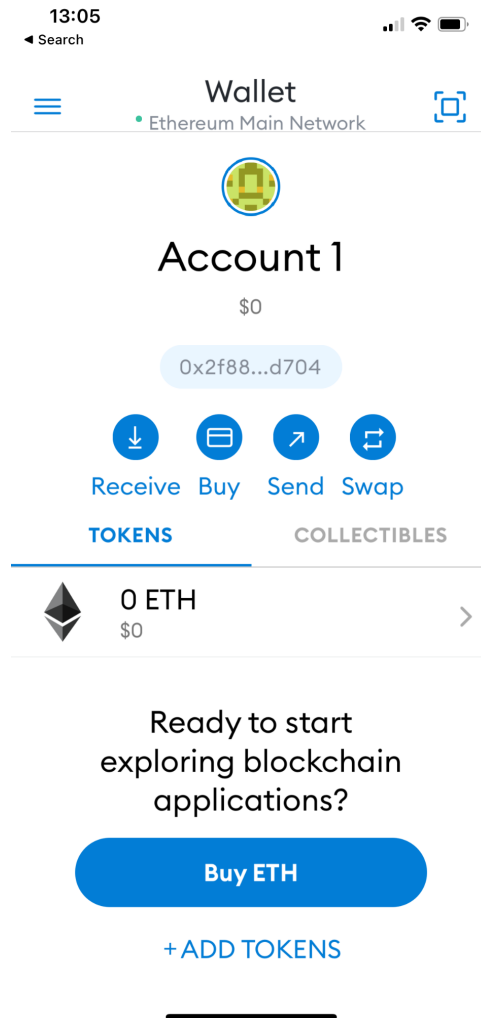

****How To Switch from Ethereum Network to Polygon Matic Network****

1. From Homepage -> Click Left Top Menu icon -> Click “ Settings “ -> From Settings menu, click “ Networks ” to add a custom network

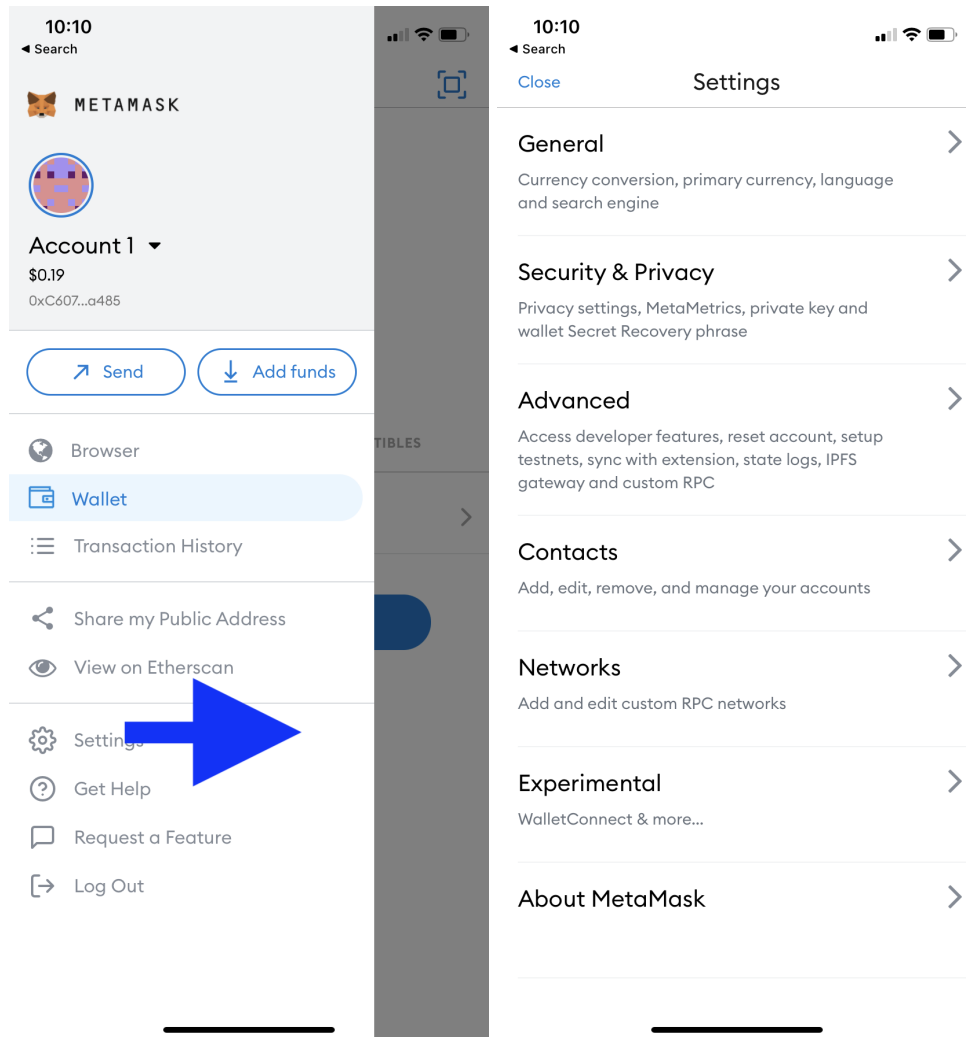

2. Click “Add Network “

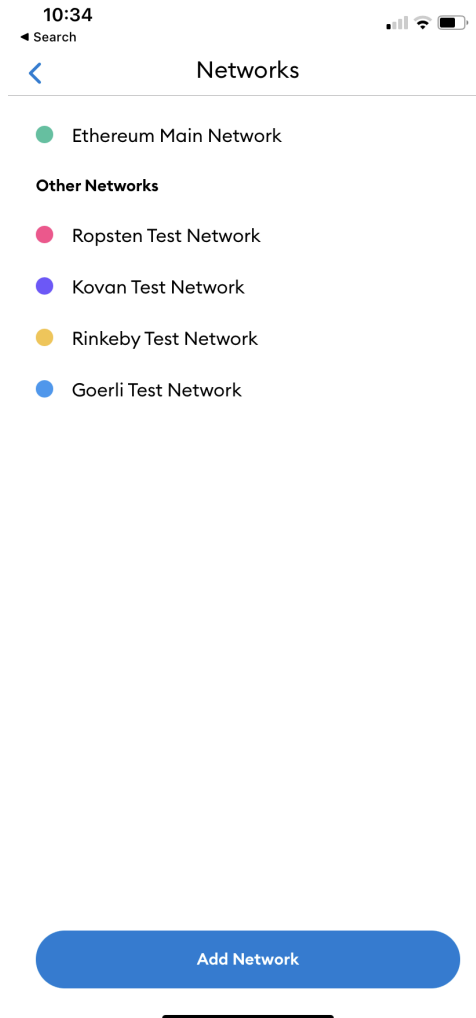

3. Enter the following information, and click “Add” in order to add Polygon network:

Network Name = “ MATIC Mainnet “
RPC Url = “ <https://rpc-mainnet.maticvigil.com> “
Chain ID = “ 137 “
Symbol = “ MATIC “
Block Explorer URL = “ <https://polygonscan.com> “

10:26

Search

Networks

Network Name

MATIC Mainnet

RPC Url

https://rpc-mainnet.maticvigil.com

Chain ID

137

Symbol

MATIC

Block Explorer URL

https://polygonscan.com

Add

1234567890

- / : ; () \$ & @ "

+= . , ? ! ' < >

ABC space return

4. Newly added “ Matic Mainnet” will be shown on the Network List -> select and click “Add Network”

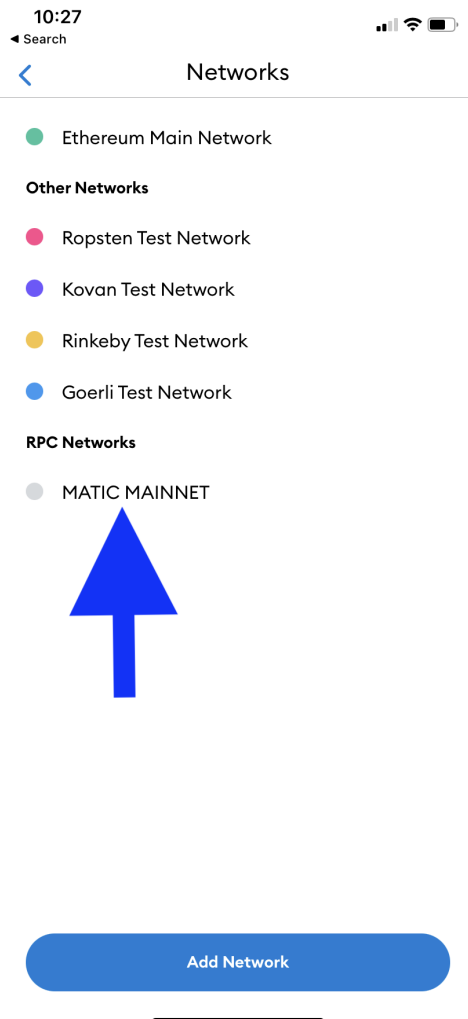

5. Exit to Wallet Homepage -> click on “Wallet” in title bar to expand Network List -> select “MATIC Mainnet” as the Network. You have now successfully switched to MATIC network !

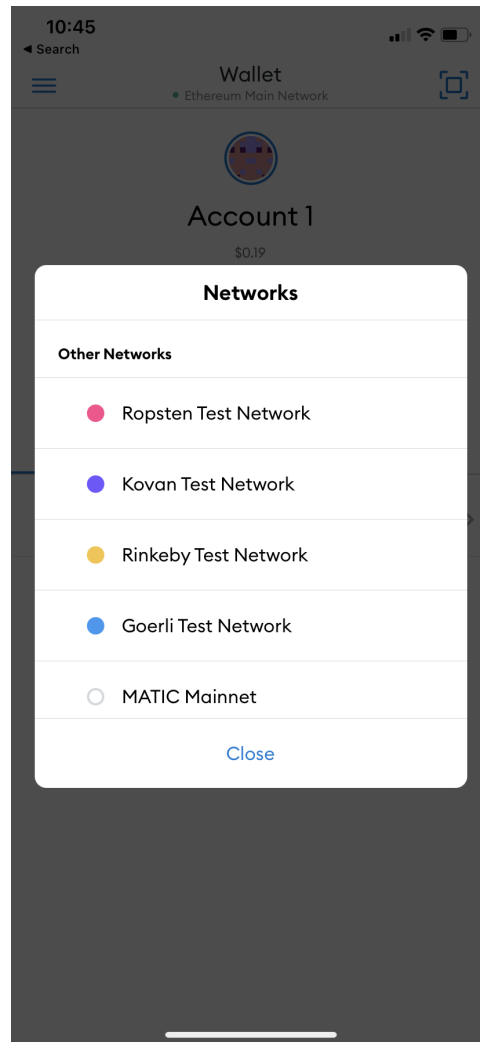

****How to Add and Display your WWC Token ****

1. Long-Click AccountName area (below Icon) to Edit Account Name to ex. “My WWC Wallet” -> Click “+ Add Tokens” Click “+ Add Tokens”

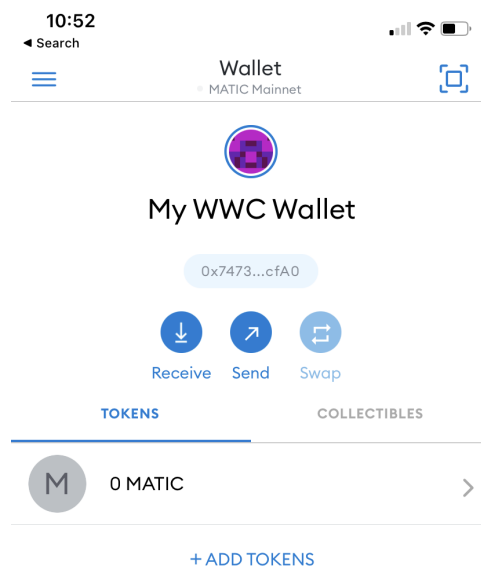

2. Enter Contract Address below in the “Token Address” field:

0x3EBDC31a24F4A61e5e86399b24F3D19D7fBD869f

If entered correctly, Token Symbol and Token Precision will be automatically shown:

The image displays two side-by-side screenshots of a mobile application interface for adding a custom token. Both screens show the 'Add Asset' screen on the 'MATIC Mainnet'.

Left Screenshot (10:50):

- Token Address:** Input field with placeholder text '0x...'.
- Token Symbol:** Input field with text 'GNO'.
- Token of Precision:** Input field with text '18'.

Right Screenshot (10:55):

- Token Address:** Input field containing the contract address '0x3EBDC31a24F4A61e5e86399b24F3D19D7fBD869f'.
- Token Symbol:** Input field with text 'WWC'.
- Token of Precision:** Input field with text '18'.

At the bottom of each screen are two buttons: 'CANCEL' and 'ADD TOKEN'.

3. Now click “Add Token”

10:55

◀ Search

⋮

📶

🔋

<

Add Asset

MATIC Mainnet

CUSTOM TOKEN

Token Address

0x3EBDC31a24F4A61e5e86399b24F3D19D7fBD869f

Token Symbol

WWC

Token of Precision

18

CANCEL

ADD TOKEN

4. There! Your WWC Token is now listed and displayed on your WeWin WWC Wallet !

